



Quick Start Guide

1

Unzip and run the **PMSocialSetup.exe** setup file.

2

If you've purchased a license, launch Photamate Social and copy the Unique ID shown in the trial dialog. Provide this ID to Photamate or the authorized reseller from whom you purchased the license to receive your unlock key.

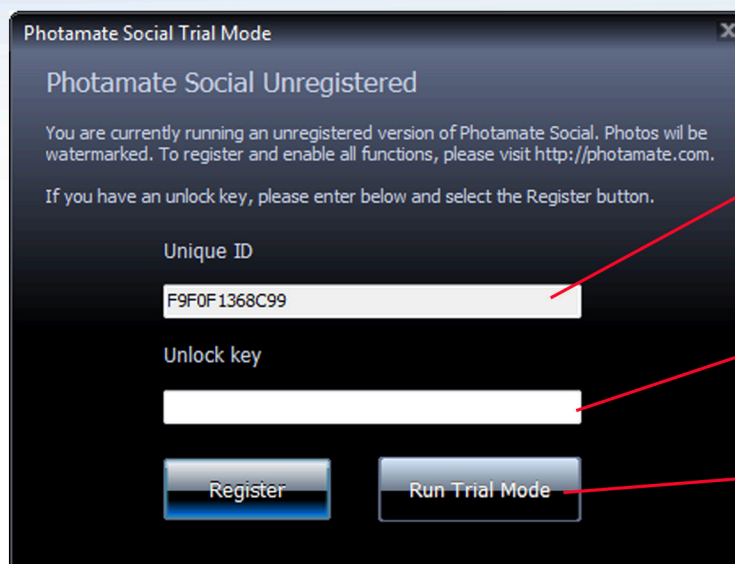

Your unique ID is valid only on the computer on which you are running the setup.

Enter the unlock key here and select the Register button.

Or, to evaluate the software, click here to run in trial mode.

3

After starting Photamate Social, hold down the Ctrl + Q keys on the keyboard to access the settings console.

4

On the General tab, choose your photo source directory or use the included sample images to test.

5

Important! Go to the Help tab within the settings console and select the Help button to learn about features and configuration parameters.